

AVAILABLE FOR LEASE
241 E Elm Street



UNITS RANGING FROM +/- 7,000 TO 25,600 SF

Mike Borski, Jr., SIOR
mborskijr@flynnco.com
(215) 561-6565 x119

Mark Pawlowski
mpawlowski@flynnco.com
(215) 561-6565 x146

Ryan Pensabene
rpensabene@flynnco.com
(215) 561-6565 x116

The
Flynn
Company

Address	241 Elm Street Conshohocken, PA
Aggregate Building Area	+/- 25,667 SF
Acres	+/- 1.06 Acres
Loading	5 Loading Docks 2 Drive-In Doors
Sewer & Water Service	Public
Sprinkler System	Dry
Electric	277/480v
Zoning	LI - Industrial

Floor Plan

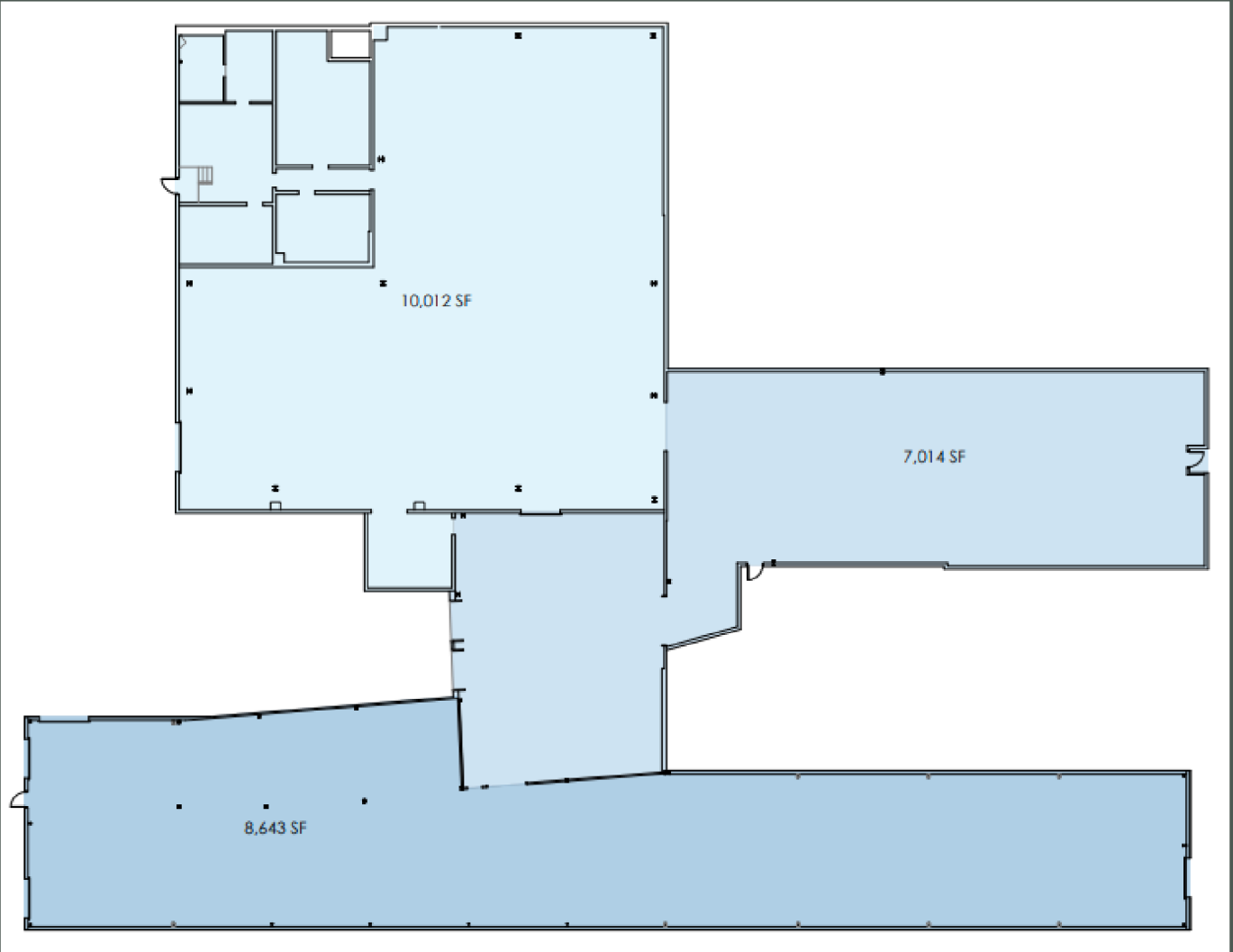

Zoning

LI - Light Industrial



Scientific or Industrial Research



Warehouse, Storage, or Distribution Center



Administrative, Business, Professional, or Corporate Offices

Location

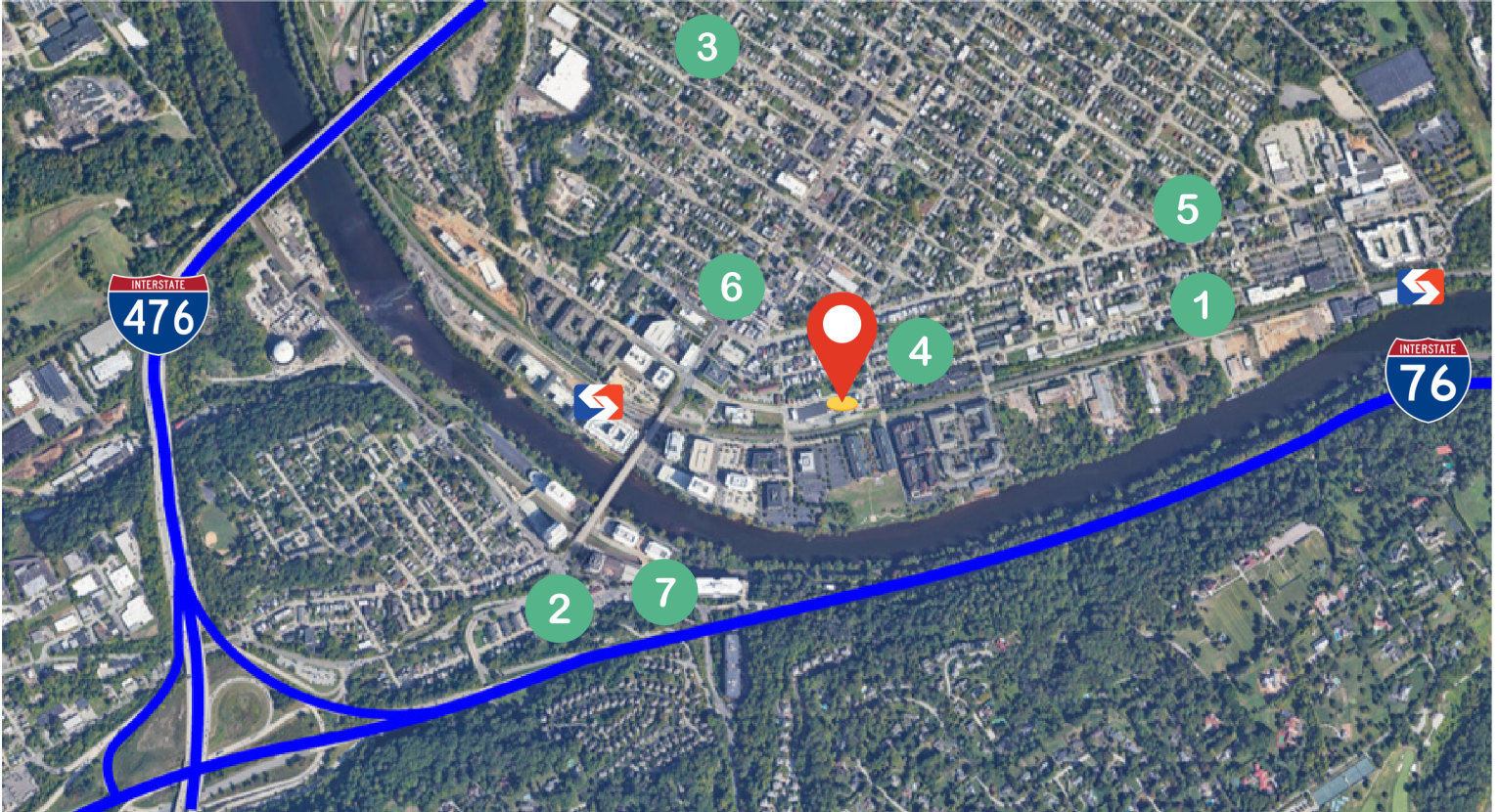

Distance to:

I-76	0.9 miles
I-476	1.2 miles
Norristown Interchange	4.5 miles
Valley Forge Interchange	6.2 miles
U.S. 202	6.4 miles

1



5



2



6



3



4



7



Property Images



Contact Information

Mike Borski, Jr.

mborskijr@flynnco.com

(215) 561 - 6565 x119

Mark Pawlowski

mpawlowski@flynnco.com

(215) 561 - 6565 x146

Ryan Pensabene

rpensabene@flynnco.com

(215) 561 - 6565 x116

The Flynn Company

(215) 561 - 6565

1621 Wood Street | Philadelphia, PA 19103

The
Flynn
Company